

目 录

一、产品概述	
General description of product	2
二、产品用途	
Applications	2
三、订货须知	
Information for Orderers	2
四、型号说明	
Example of model designation	3
五、型谱图	
Performance Spectrum	4
3D 型油田往复泵型谱图	
Performance Spectrum of 3D Series Reciprocating Pumps for Oilfield	4
5D 型油田往复泵型谱图	
Performance Spectrum of 5D Series Reciprocating Pumps for Oilfield	4
六、油田往复泵性能参数表	
Performance Parameter of Series Reciprocating Pumps for Oilfield	5
3D2P 型油田往复泵性能参数表	
Performance Parameter of 3D2P Series Reciprocating Pumps for Oilfield	5
3D3P 型油田往复泵性能参数表	
Performance Parameter of 3D3P Series Reciprocating Pumps for Oilfield	6
3D4P 型油田往复泵性能参数表	
Performance Parameter of 3D4P Series Reciprocating Pumps for Oilfield	8
3D6P 型油田往复泵性能参数表	
Performance Parameter of 3D6P Series Reciprocating Pump for Oilfield	10
3D7P 型往复泵性能参数表	
Performance Parameter of 3D7P Series Reciprocating Pumps for Oilfield	12
3D8 型油田往复泵性能参数表	
Performance Parameter of 3D8 Series Reciprocating Pumps for Oilfield	13
3D9 型油田往复泵性能参数表	
Performance Parameter of 3D9 Series Reciprocating Pumps for Oilfield	15
5D6P 型油田往复泵性能参数表	
Performance Parameter of 5D6P Series Reciprocating Pumps for Oilfield	16
5D7P 型往复泵性能参数表	
Performance Parameter of 5D7P Series Reciprocating Pumps for Oilfield	18
七、3DP 型油田往复泵外形尺寸图	
Outline Dimension Drawing of 3DP Series Reciprocating Pumps for Oilfield	20
八、5DP 型油田往复泵外形尺寸图	
Outline Dimension Drawing of 5DP Series Reciprocating Pumps for Oilfield	20

油田往复泵

Reciprocating Pumps for Oilfield

一、产品概述

本系列油田往复泵，采用 GB9234 及 API674 标准设计制造，共有 9 个机座系列，规格齐全，流量达 150m³/h，排出压力达 80MPa，配带功率达 710kW；常规型泵输送介质粘度≤850cp、温度≤60℃；特殊设计的液力端，输送介质可达更高粘度及更高温度，若配带变频电机及变频器，还可进行流量调节。

General description of product

This series of oilfield reciprocating pumps are designed and manufactured in accordance with GB 9234 and API 674, with 9 frame series and complete specifications, offering capacity up to 150 m³/h, discharge pressure up to 80 MPa, and motor power up to 710 kW. Conventional pumps transfer liquids of viscosity ≤ 850cp and temperature ≤ 60°C; and the pump designed with special liquid end can transfer liquids of still higher viscosity and temperature. With variable-frequency motor and convertor, the pump capacity can be adjusted.

二、产品用途

本系列油田往复泵主要用于油田注水、注聚、固井、酸化、压裂，也可用于高压清洗、钢厂高压水除鳞、水压机、试压等。

Applications

This series of oilfield reciprocating pumps are mainly used for oilfield water injection, polymer injection, well cementation, acidification, and fracture in oil industry, also suitable for high-pressure cleaning, high-pressure descaling for rolled steel, hydraulic press, hydrotest, etc.

三、订货须知

订货时请注明输送介质的物理性能和化学特性（如介质名称、工作压力、比重、浓度、温度、粘度、PH 值、气化压力等）。

Information for Orderers

Please specify physical and chemical properties of liquids to be pumped when ordering, such as name of liquid, working pressure, specific gravity, density, temperature, viscosity, PH value, vapor pressure, etc.

四、型号说明

Example of model designation

例: 3 D 6 P-280-50 N 132-□-□

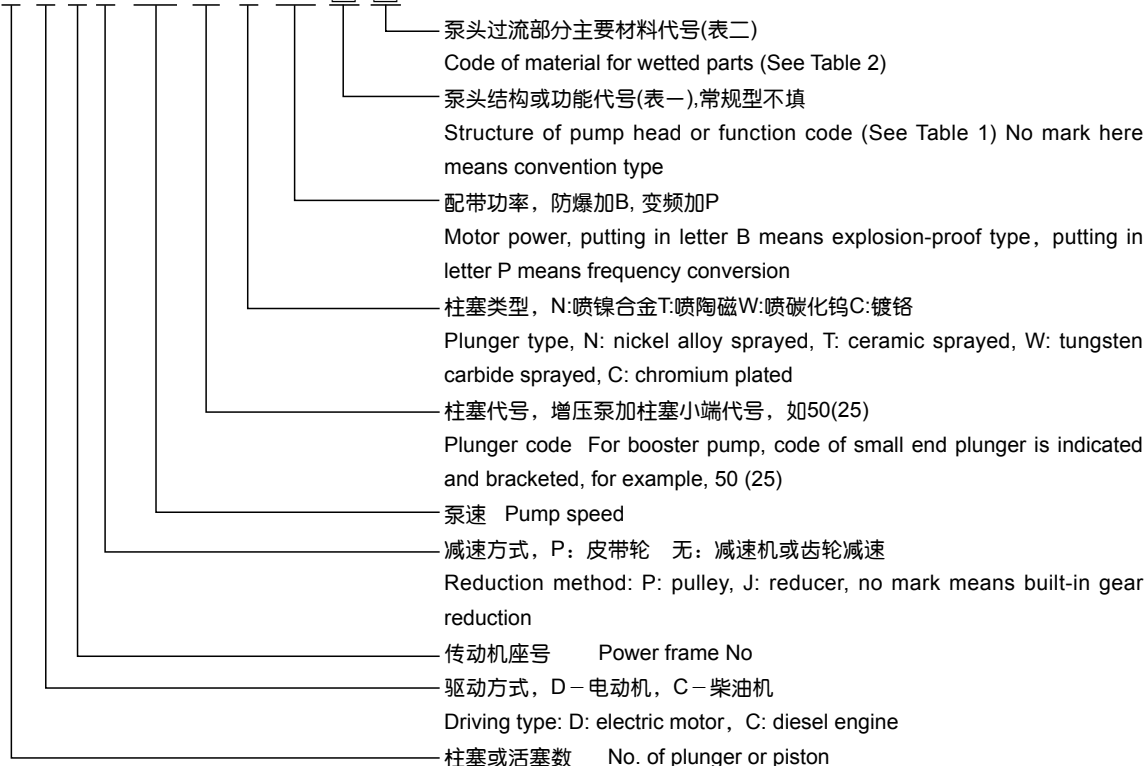

注: 性能参数表中仅为基本型号, 完整型号应按上面格式填写。

Notes: Models shown in performance parameter tables hereinafter are basic models. The concrete model should be completed according to the above explanation.

特殊功能代号表 (Code of Specific Function)

表一 (Table 1)

代号 Code	R0	R1	R2	R1N	R2N
主要用途 Main application	保温 Heat insulation			耐高温 Heat resistant	
	-30 ~ 80°C	80 ~ 150°C	150 ~ 350°C	80 ~ 150°C	150 ~ 350°C
代号 Code	GN	H	S	G	T
主要用途 Main application	高粘度 High viscosity 850 ~ 3000CP	填料箱带回流孔 Stuffing box with return-flow hole	双级填料箱带冲洗 Double stage stuffing box with flushing	填料箱隔环带冲洗 Stuffing box spacer ring with flushing	用户其它特殊要求 Other requirements by customers

注: 1. 特殊功能代号按英文顺序书写, 用"/"分界;

Notes: codes of specific function to be written in alphabetical order, separated with mark "/"

泵头缸过流部份主要材料 (Main Materials for Wetted Parts of Pump Head)

表二 (Table 2)

材料代号 Code	I	III	IV	V	V B
材料牌号 Grade	35/35CrMo	2Cr13/420	1Cr18Ni9Ti/304	1Cr18Ni12Mo2Ti/316	316L

五、型谱图

Performance Spectrum

3D 型油田往复泵型谱图

Performance Spectrum of 3D Series Reciprocating Pumps for Oilfield

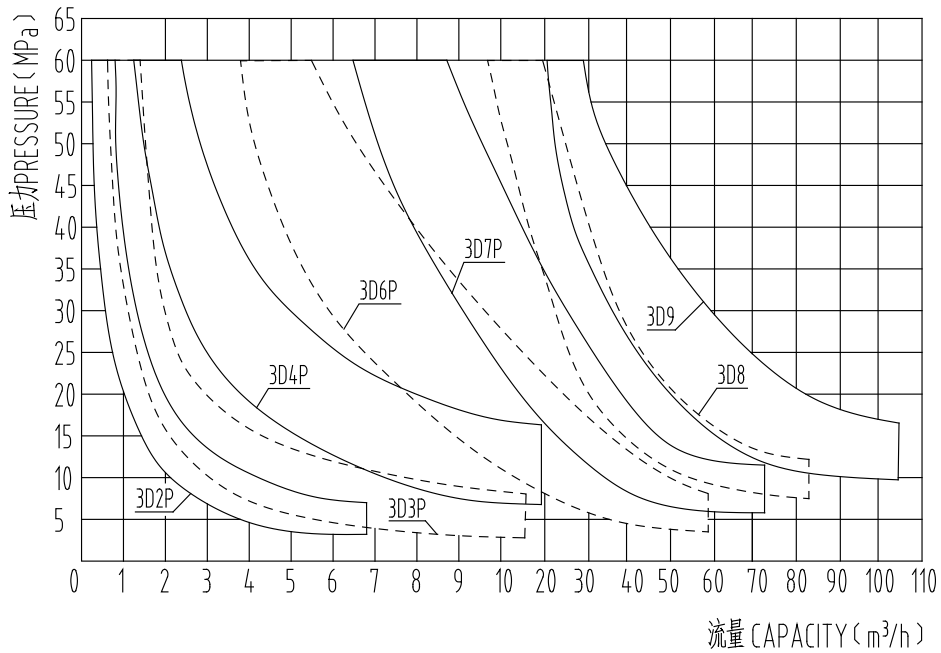

5D 型油田往复泵型谱图

Performance Spectrum of 5D Series Reciprocating Pumps for Oilfield

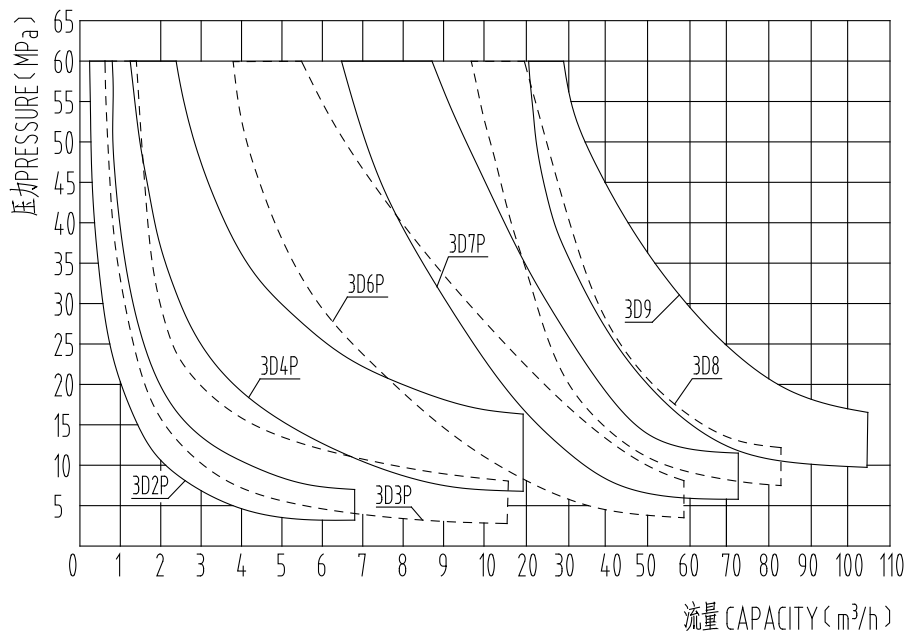

六、油田往复泵性能参数表

Performance Parameter of Series Reciprocating Pumps for Oilfield

3D2P 型油田往复泵性能参数表

Performance Parameter of 3D2P Series Reciprocating Pumps for Oilfield

基本型号 Basic model	额定流量 Rated capacity m ³ /h	排出压力 Discharge pressure MPa	柱塞直径 Plunger dia. mm	泵速 Pump speed min-1	电机 Motor		进口外径 × 壁厚 Inlet dia. × wall thickness mm	出口外径 × 壁厚 Outlet dia. × wall thickness mm	重量 WeightKg	
					功率 Power kW	级数 No. of stage				
3D2P-193-16N11	0.42	50 ~ 60	16	193	11	8	34 × 3	27 × 7	≈ 860	
3D2P-235-16N15	0.52	50 ~ 63		235	15	8				
3D2P-235-16N11		40 ~ 50			11	8				
3D2P-256-16N15	0.56	45 ~ 63		256	15	6				
3D2P-256-16N11		40 ~ 45			11	6				
3D2P-292-16N18	0.64	50 ~ 63		292	18.5	8				
3D2P-292-16N15		40 ~ 50			15	8				
3D2P-313-16N18	0.7	50 ~ 63		313	18.5	6				
3D2P-313-16N15		40 ~ 50	15		6					
3D2P-193-20N15	0.67	32 ~ 40	20	193	15	8				
3D2P-193-20N11		25 ~ 32			11	8				
3D2P-235-20N15	0.82	32 ~ 40		235	15	8				
3D2P-235-20N11		25 ~ 32			11	8				
3D2P-256-20N15	0.9	30 ~ 40		256	15	6				
3D2P-256-20N11		25 ~ 30			11	6				
3D2P-292-20N18	1	32 ~ 40		292	18.5	8				
3D2P-292-20N15		25 ~ 32			15	8				
3D2P-313-20N18	1.1	32 ~ 40		313	18.5	6				
3D2P-313-20N15		25 ~ 32			15	6				
3D2P-193-25N11	1.1	20 ~ 24		25	193	11	8	42 × 3.5	42 × 10	≈ 890
3D2P-235-25N15	1.3	19 ~ 25			235	15	8			
3D2P-235-25N11		16 ~ 19				11	8			
3D2P-256-25N15	1.45	18 ~ 25			256	15	6			
3D2P-256-25N11		16 ~ 18				11	6			
3D2P-292-25N18	1.65	20 ~ 25			292	18.5	8			
3D2P-292-25N15		16 ~ 20	15			8				
3D2P-313-25N18	1.75	20 ~ 25	313		18.5	6				
3D2P-313-25N15		16 ~ 20		15	6					
3D2P-193-32N11	1.8	12.5 ~ 14	32	193	11	8				
3D2P-235-32N15	2.2	12 ~ 16		235	15	8				
3D2P-235-32N11		10 ~ 12			11	8				
3D2P-256-32N15	2.4	11.5 ~ 15		256	15	6				
3D2P-256-32N11		10 ~ 11.5			11	6				
3D2P-292-32N18	2.75	12.5 ~ 16		292	18.5	8				
3D2P-292-32N15		10 ~ 12.5			15	8				

基本型号 Basic model	额定流量 Rated capacity m ³ /h	排出压力 Discharge pressure MPa	柱塞直径 Plunger dia. mm	泵速 Pump speed min-1	电机 Motor		进口外径 × 壁厚 Inlet dia. × wall thickness mm	出口外径 × 壁厚 Outlet dia. × wall thickness mm	重量 WeightKg
					功率 Power kW	级数 No. of stage			
3D2P-313-32N18	2.95	12.5 ~ 15.5	32	313	18.5	6	42 × 3.5	42 × 10	≈ 890
3D2P-313-32N15		10 ~ 12.5			15	6			
3D2P-193-40N11	2.9	8 ~ 9	40	193	11	8	60 × 4	48 × 5.5	≈ 950
3D2P-235-40N15	3.5	8 ~ 10		235	15	8			
3D2P-235-40N11		6.3 ~ 8			11	8			
3D2P-256-40N15	3.8	7 ~ 10		256	15	6			
3D2P-256-40N11		6 ~ 7			11	6			
3D2P-292-40N18	4.35	8 ~ 10		292	18.5	8			
3D2P-292-40N15		6.3 ~ 8			15	8			
3D2P-313-40N18	4.65	8 ~ 10		313	18.5	6			
3D2P-313-40N15		6.3 ~ 8			15	6			
3D2P-193-48N11	4.1	5 ~ 6.3		48	193	11			
3D2P-235-48N15	5	5 ~ 6.3	235		15	8			
3D2P-235-48N11		4 ~ 5			11	8			
3D2P-256-48N15	5.5	5 ~ 6.3	256		15	6			
3D2P-256-48N11		4 ~ 5			11	6			
3D2P-292-48N15	6.3	5 ~ 6	292		15	8			
3D2P-313-48N18	6.8	5 ~ 6.3	313		18.5	6			
3D2P-313-48N15		4 ~ 5			15	6			

注: 表中为标准系列规格, 应优先选取。其它可选柱塞直径为: 18、22、28、36、45。

行程: 70mm, 柱塞推力1300kg

Notes: Plunger diameters shown in the table are of standard series specifications that have the precedence over all others, secondly the 18, 22, 28, 36 and 45.

Stroke: 70 mm plunger thrust:1300kg

3D3P 型油田往复泵性能参数表
Performance Parameter of 3D3P Series Reciprocating Pumps for Oilfield

基本型号 Basic model	额定流量 Rated capacity m ³ /h	排出压力 Discharge pressure MPa	柱塞直径 Plunger dia. mm	泵速 Pump speed min-1	电机 Motor		进口外径 × 壁厚 Inlet dia. × wall thickness mm	出口外径 × 壁厚 Outlet dia. × wall thickness mm	重量 WeightKg
					功率 Power kW	级数 No. of stage			
3D3P-222-20N22	0.87	50~60	20	222	22	8	42 × 3.5	42 × 10	1000
3D3P-222-20N18		40~50			18.5	8			
3D3P-251-20N22	1	46~55		251	22	8			
3D3P-251-20N18		40~46			18.5	8			
3D3P-277-20N30	1.1	48~63		277	30	8			
3D3P-277-20N22		40~48			22	8			

基本型号 Basic model	额定流量 Rated capacity m ³ /h	排出压力 Discharge pressure MPa	柱塞直径 Plunger dia. mm	泵速 Pump speed min-1	电机 Motor		进口外径 × 壁厚 Inlet dia. × wall thickness mm	出口外径 × 壁厚 Outlet dia. × wall thickness mm	重量 WeightKg															
					功率 Power kW	级数 No. of stage																		
3D3P-295-20N30	1.15	46~63	20	295	30	6	42 × 3.5	42 × 10	1000															
3D3P-295-20N22		40~46			22	6																		
3D3P-333-20N37	1.3	50~63		333	37	6																		
3D3P-333-20N30		40~50			30	6																		
3D3P-222-25N22	1.4	31~37	25	222	22	8				42 × 3.5	42 × 10	1000												
3D3P-222-25N18		25~31			18.5	8																		
3D3P-251-25N22	1.6	28~33		251	22	8																		
3D3P-251-25N18		25~28			18.5	8																		
3D3P-277-25N30	1.75	30~40	277	30	8	42 × 3.5							42 × 10	1000										
3D3P-277-25N22		25~30		22	8																			
3D3P-295-25N30	1.9	30~40	295	30	6										42 × 3.5	42 × 10	1000							
3D3P-295-25N22		25~30		22	6																			
3D3P-333-25N37	2.1	32~40	333	37	6		42 × 3.5	42 × 10	1000															
3D3P-333-25N30		25~32		30	6																			
3D3P-222-32N22	2.3	20~23	32	222	22													8	60 × 4	48 × 10	1100			
3D3P-222-32N18		16~20			18.5													8						
3D3P-251-32N22	2.65	17~20.5		251	22					8														
3D3P-251-32N18		16~17			18.5					8														
3D3P-277-32N30	2.9	18.5~25	277	30	8					60 × 4	48 × 10	1100												
3D3P-277-32N22		16~18.5		22	8																			
3D3P-295-32N30	3.1	18~24	295	30	6	60 × 4							48 × 10	1100										
3D3P-295-32N22		16~18		22	6																			
3D3P-333-32N37	3.5	20~25	333	37	6										60 × 4	48 × 10	1100							
3D3P-333-32N30		16~20		30	6																			
3D3P-222-40N22	3.7	13~15	40	222	22		8	60 × 4	48 × 10									1100						
3D3P-222-40N18		10~12.5			18.5		8																	
3D3P-251-40N22	4.2	11~13.5		251	22		8												60 × 4	48 × 10	1100			
3D3P-251-40N18		10~11			18.5		8																	
3D3P-277-40N30	4.65	12~16	277	30	8		60 × 4															48 × 10	1100	
3D3P-277-40N22		10~12		22	8																			
3D3P-295-40N30	4.9	11~15	295	30	6					60 × 4	48 × 10	1100												
3D3P-295-40N22		10~11		22	6																			
3D3P-333-40N37	5.6	13~16	333	37	6	60 × 4							48 × 10	1100										
3D3P-333-40N30		10~13		30	6																			
3D3P-222-50N22	5.85	8~9.5	50	222	22										8	89 × 5	76 × 10							1200
3D3P-222-50N18		6.3~8			18.5										8									
3D3P-251-50N22	6.7	7~8.5		251	22			8	89 × 5						76 × 10			1200						
3D3P-251-50N18		6.3~7			18.5			8																
3D3P-277-50N30	7.4	7.5~10	277	30	8			89 × 5											76 × 10	1200				
3D3P-277-50N22		6.3~7.5		22	8																			

基本型号 Basic model	额定流量 Rated capacity m ³ /h	排出压力 Discharge pressure MPa	柱塞直径 Plunger dia. mm	泵速 Pump speed min-1	电机 Motor		进口外径 × 壁厚 Inlet dia. × wall thickness mm	出口外径 × 壁厚 Outlet dia. × wall thickness mm	重量 WeightKg
					功率 Power kW	级数 No. of stage			
3D3P-295-50N30	7.9	7.5~10	50	295	30	6	89 × 5	76 × 10	1200
3D3P-295-50N22		6.3~7.5			22	6			
3D3P-333-50N37	8.9	8~10		333	37	6			
3D3P-333-50N30		6.3~8			30	6			
3D3P-222-65N22	10	4.6~5.5	65	222	22	8			
3D3P-222-65N18		3.5~4.6			18.5	8			
3D3P-251-65N30	11.4	5~6.3		251	30	8			
3D3P-251-65N22		4~5			22	8			
3D3P-277-65N30	12.5	4.5~6.3		277	30	8			
3D3P-277-65N22		4~4.5			22	8			
3D3P-295-65N30	13.4	4.3~6		295	30	6			
3D3P-295-65N22		4~4.3			22	6			
3D3P-333-65N37	15.2	5~6.3		333	37	6			
3D3P-333-65N30		4~5			30	6			

注: 表中为标准系列规格, 应优先选取。其它可选柱塞直径为: 22、28、36、45、56。

行程: 80mm, 柱塞推力: 2000Kg

Notes: Plunger diameters shown in the table are of standard series specifications that have the precedence over all others, secondly the 22, 28, 36, 45 and 56.

Stroke: 80 mm plunger thrust: 2000 kg

3D4P 型油田往复泵性能参数表
Performance Parameter of 3D4P Series Reciprocating Pumps for Oilfield

基本型号 Basic model	额定流量 Rated capacity m ³ /h	排出压力 Discharge pressure MPa	柱塞直径 Plunger dia. mm	泵速 Pump speed min-1	电机 Motor		进口外径 × 壁厚 Inlet dia. × wall thickness mm	出口外径 × 壁厚 Outlet dia. × wall thickness mm	重量 WeightKg	
					功率 Power kW	级数 No. of stage				
3D4P-148-25N37	1.15	63 ~ 80	25	148	37	8	48 × 3.5	48 × 12	≈ 2300	
3D4P-148-25N30		50 ~ 63			30	8				
3D4P-185-25N45	1.45	63 ~ 80		185	45	8				
3D4P-185-25N37		50 ~ 63			37	8				
3D4P-211-25N55	1.65	63 ~ 80		211	55	8				
3D4P-211-25N45		50 ~ 63			45	8				
3D4P-245-25N55	1.9	58 ~ 72		245	55	6				
3D4P-245-25N45		50 ~ 58			45	6				
3D4P-280-25N75	2.2	63 ~ 80		280	75	6				
3D4P-280-25N55		50 ~ 63			55	6				
3D4P-148-32N37	1.9	40 ~ 50		32	148	37				8
3D4P-148-32N30		32 ~ 40				30				8

基本型号 Basic model	额定流量 Rated capacity m ³ /h	排出压力 Discharge pressure MPa	柱塞直径 Plunger dia. mm	泵速 Pump speed min-1	电机 Motor		进口外径 × 壁厚 Inlet dia. × wall thickness mm	出口外径 × 壁厚 Outlet dia. × wall thickness mm	重量 WeightKg
					功率 Power kW	级数 No. of stage			
3D4P-185-32N45	2.4	39 ~ 47	32	185	45	8	48 × 3.5	48 × 12	≈ 2300
3D4P-185-32N37		32 ~ 39			37	8			
3D4P-211-32N55	2.75	40 ~ 50		211	55	8			
3D4P-211-32N45		32 ~ 40			45	8			
3D4P-245-32N55	3.2	35 ~ 43		245	55	6			
3D4P-245-32N45		32 ~ 35			45	6			
3D4P-280-32N75	3.6	38 ~ 50		280	75	6			
3D4P-280-32N55		32 ~ 38			55	6			
3D4P-330-32N75	4.3	33 ~ 45		330	75	6			
3D4P-330-32N55		22 ~ 33			55	6			
3D4P-148-40N37	3	24 ~ 30	40	148	37	8	76 × 5	60 × 11	≈ 2500
3D4P-148-40N30		20 ~ 24			30	8			
3D4P-185-40N45	3.8	24 ~ 30		185	45	8			
3D4P-185-40N37		20 ~ 24			37	8			
3D4P-211-40N55	4.3	22 ~ 32		211	55	8			
3D4P-211-40N37		20 ~ 23			37	8			
3D4P-245-40N55	5	23.5 ~ 28.5		245	55	6			
3D4P-245-40N45		20 ~ 23.5			45	6			
3D4P-280-40N75	5.75	25 ~ 32		280	75	6			
3D4P-280-40N55		20 ~ 25			55	6			
3D4P-330-40N75	6.9	21 ~ 29	330	75	6				
3D4P-330-40N55		14 ~ 21		55	6				
3D4P-148-50N37	4.8	16 ~ 20	50	148	37	8	76 × 5	60 × 11	≈ 2500
3D4P-148-50N30		13 ~ 16			30	8			
3D4P-185-50N45	6	16 ~ 20		185	45	8			
3D4P-185-50N37		13 ~ 16			37	8			
3D4P-211-50N55	6.9	16 ~ 20		211	55	8			
3D4P-211-50N45		13 ~ 16			45	8			
3D4P-245-50N55	8	14.5 ~ 18		245	55	6			
3D4P-245-50N45		12.5 ~ 14.5			45	6			
3D4P-280-50N75	9.2	16 ~ 20		280	75	6			
3D4P-280-50N55		13 ~ 16			55	6			
3D4P-330-50N75	10.9	12.5 ~ 17	330	75	6				
3D4P-330-50N55		8 ~ 12.5		55	6				
3D4P-148-65N37	8.2	10 ~ 12	65	148	37	8	102 × 5	76 × 9	≈ 2700
3D4P-148-65N30		8 ~ 10			30	8			
3D4P-185-65N45	10.3	9.5 ~ 11.5		185	45	8			
3D4P-185-65N37		8 ~ 9.5			37	8			
3D4P-211-65N55	11.8	10 ~ 12.5		211	55	8			
3D4P-211-65N45		8 ~ 10			45	8			

基本型号 Basic model	额定流量 Rated capacity m ³ /h	排出压力 Discharge pressure MPa	柱塞直径 Plunger dia. mm	泵速 Pump speed min-1	电机 Motor		进口外径 × 壁厚 Inlet dia. × wall thickness mm	出口外径 × 壁厚 Outlet dia. × wall thickness mm	重量 WeightKg
					功率 Power kW	级数 No. of stage			
3D4P-245-65N55	13.7	8.5 ~ 10.5	65	245	55	6	102 × 5	76 × 9	≈ 2700
3D4P-245-65N45		7 ~ 8.5			45	6			
3D4P-280-65N75	15.7	9.5 ~ 12.5		280	75	6			
3D4P-280-65N55		8 ~ 9.5			55	6			
3D4P-330-65N75	18.5	8 ~ 11		330	75	6			
3D4P-330-65N55		5 ~ 8			55	6			

注：表中为标准系列规格，应优先选取。其它可选柱塞直径为：28、36、45、56。

行程：100mm，柱塞推力：4000Kg

Notes: Plunger diameters shown in the table are of standard series specifications that have the precedence over all others, secondly the 28, 36, 45 and 56.

Stroke: 100 mm plunger thrust: 4000 kg

3D6P 型油田往复泵性能参数表
 Performance Parameter of 3D6P Series Reciprocating Pump for Oilfield

基本型号 Basic model	额定流量 Rated capacity m ³ /h	排出压力 Discharge pressure MPa	柱塞直径 Plunger dia. mm	泵速 Pump speed min-1	电机 Motor		进口外径 × 壁厚 Inlet dia. × wall thickness mm	出口外径 × 壁厚 Outlet dia. × wall thickness mm	重量 WeightKg				
					功率 Power kW	级数 No. of stage							
3D6P-185-40N90	4.7	40 ~ 48	40	185	90	6	76 × 5	76 × 18	≈ 4300				
3D6P-185-40N75		32 ~ 40			75	6							
3D6P-200-40N90	5.1	38 ~ 45		200	90	8							
3D6P-200-40N75		32 ~ 38			75	8							
3D6P-230-40N110	5.9	40 ~ 48		230	110	6							
3D6P-230-40N90		32 ~ 40			90	6							
3D6P-280-40N132	7.1	40 ~ 48		280	132	4							
3D6P-280-40N110		32 ~ 40			110	4							
3D6P-344-40N180	8.7	46 ~ 48		344	180	4							
3D6P-344-40N132		32 ~ 40			132	4							
3D6P-185-50N90	7.5	25 ~ 32		50	185	90				6	114 × 6	114 × 18	≈ 4500
3D6P-185-50N75		20 ~ 25				75				6			
3D6P-200-50N90	8.1	24 ~ 28.5	200		90	8							
3D6P-200-50N75		20 ~ 24			75	8							
3D6P-230-50N110	9.3	25 ~ 30.5	230		110	6							
3D6P-230-50N90		20 ~ 25			90	6							
3D6P-280-50N132	11.4	25 ~ 30.5	280		132	4							
3D6P-280-50N110		20 ~ 25			110	4							
3D6P-344-50N160	13.9	25 ~ 30	344		160	4							
3D6P-344-50N132		20 ~ 25			132	4							

基本型号 Basic model	额定流量 Rated capacity m ³ /h	排出压力 Discharge pressure MPa	柱塞直径 Plunger dia. mm	泵速 Pump speed min-1	电机 Motor		进口外径 × 壁厚 Inlet dia. × wall thickness mm	出口外径 × 壁厚 Outlet dia. × wall thickness mm	重量 WeightKg
					功率 Power kW	级数 No. of stage			
3D6P-185-65N90	12.9	16 ~ 18.5	65	185	90	6	114 × 6	114 × 18	≈ 4500
3D6P-185-65N75		13 ~ 15.5			75	6			
3D6P-200-65N110	14	17 ~ 20		200	110	8			
3D6P-200-65N75		12 ~ 14			75	8			
3D6P-230-65N110	16	15 ~ 18		230	110	6			
3D6P-230-65N90		13 ~ 15			90	6			
3D6P-280-65N132	19.5	15 ~ 18.5		280	132	4			
3D6P-280-65N110		13 ~ 15			110	4			
3D6P-344-65N180	24.2	18 ~ 20		344	180	4			
3D6P-344-65N132		12 ~ 15			132	4			
3D6P-185-80N90	19.7	10 ~ 12.5	80	185	90	6	168 × 7	114 × 11	≈ 4800
3D6P-185-80N75		8 ~ 10			75	6			
3D6P-200-80N90	21.3	9.5 ~ 11.5		200	90	8			
3D6P-200-80N75		8 ~ 9.5			75	8			
3D6P-230-80N110	24.5	10 ~ 12		230	110	6			
3D6P-230-80N90		8 ~ 10			90	6			
3D6P-280-80N132	29.8	10 ~ 12		280	132	4			
3D6P-280-80N110		8 ~ 10			110	4			
3D6P-344-80N160	36.5	10 ~ 12		344	160	4			
3D6P-344-80N132		8 ~ 10			132	4			
3D6P-185-100N90	31.5	6.3 ~ 8	100	185	90	6	168 × 7	114 × 11	≈ 4800
3D6P-185-100N75		5 ~ 6.3			75	6			
3D6P-200-100N90	33.8	6 ~ 7.3		200	90	8			
3D6P-200-100N75		5 ~ 6			75	8			
3D6P-230-100N110	38.9	6.3 ~ 8		230	110	6			
3D6P-230-100N90		5 ~ 6.3			90	6			
3D6P-280-100N132	47.5	6.3 ~ 8		280	132	4			
3D6P-280-100N110		5 ~ 6.3			110	4			
3D6P-344-100N160	58.2	6.3 ~ 7.5		344	160	4			
3D6P-344-100N132		5 ~ 6.3			132	4			

注: 表中为标准系列参数, 应优先选取。其它可选柱塞(活塞)直径为: 36、45、56、70、90、110、125、140。

行程: 126mm, 柱塞推力: 6300Kg

Notes: Plunger diameters shown in the table are of standard series specifications that have the precedence over all others, secondly the 36, 45, 56, 70, 90, 110, 125 and 140.

Stroke: 126 mm plunger thrust: 6300 kg

3D7P 型往复泵性能参数表
Performance Parameter of 3D7P Series Reciprocating Pumps for Oilfield

基本型号 Basic model	额定流量 Rated capacity m ³ /h	排出压力 Discharge pressure MPa	柱塞直径 Plunger dia. mm	泵速 Pump speed min-1	电机 Motor		进口外径 × 壁厚 Inlet dia. × wall thickness mm	出口外径 × 壁厚 Outlet dia. × wall thickness mm	重量 WeightKg				
					功率 Power kW	级数 No. of stage							
3D7P-185-40N185	6	70 ~ 78	40	185	185	8	89 × 5	89 × 20	≈ 6500				
3D7P-185-40N132		50 ~ 58			132	8							
3D7P-211-40N220	6.8	70 ~ 77		211	220	8							
3D7P-211-40N160		50 ~ 60			160	8							
3D7P-246-40N220	7.9	65 ~ 71		246	220	6							
3D7P-246-40N180		53 ~ 60			180	6							
3D7P-281-40N280	9.1	70 ~ 80		281	280	6							
3D7P-281-40N220		50 ~ 60			220	6							
3D7P-185-50N185	9.3	43 ~ 50		50	185	185				8	89 × 5	89 × 20	≈ 6500
3D7P-185-50N132		31.5 ~ 36				132				8			
3D7P-211-50N200	10.6	45 ~ 50			211	200				8			
3D7P-211-50N160		33 ~ 40				160				8			
3D7P-246-50N220	12.5	42 ~ 46	246		220	6							
3D7P-246-50N180		34 ~ 38			180	6							
3D7P-281-50N250	14.2	42 ~ 46	281		250	6							
3D7P-281-50N200		32 ~ 36			200	6							
3D7P-185-65N185	16.2	25 ~ 30	65		185	185	8	140 × 6.5	114 × 18	≈ 7000			
3D7P-185-65N160		20 ~ 25				160	8						
3D7P-211-65N220	18.5	29 ~ 32			211	220	8						
3D7P-211-65N160		20 ~ 24				160	8						
3D7P-246-65N250	21.5	28 ~ 32		246	250	6							
3D7P-246-65N200		22 ~ 25			200	6							
3D7P-281-65N280	24.8	28 ~ 30		281	280	6							
3D7P-281-65N220		22 ~ 25			220	6							
3D7P-328-65N315	29	27.5 ~ 30		328	315	6							
3D7P-328-65N250		22 ~ 24			250	6							
3D7P-185-80N185	25.2	18 ~ 20		80	185	185	8				140 × 6.5	114 × 18	≈ 7000
3D7P-185-80N132		12.5 ~ 15				132	8						
3D7P-211-80N200	28.6	18 ~ 20	211		200	8							
3D7P-211-80N160		13 ~ 16			160	8							
3D7P-246-80N220	33.3	16.5 ~ 18	246		220	6							
3D7P-246-80N180		12 ~ 15			180	6							
3D7P-281-80N280	38.2	18 ~ 20	281		280	6							
3D7P-281-80N220		13 ~ 16			220	6							
3D7P-328-80N315	44.5	18 ~ 20	328		315	6							
3D7P-328-80N250		13 ~ 15			250	6							
3D7P-185-100N185	39.2	11 ~ 12.5	100		185	185	8	219 × 8	140 × 15	≈ 7500			
3D7P-185-100N132		8 ~ 9				132	8						
3D7P-211-100N200	44.6	11 ~ 12.5		211	200	8							

基本型号 Basic model	额定流量 Rated capacity m ³ /h	排出压力 Discharge pressure MPa	柱塞直径 Plunger dia. mm	泵速 Pump speed min-1	电机 Motor		进口外径 × 壁厚 Inlet dia. × wall thickness mm	出口外径 × 壁厚 Outlet dia. × wall thickness mm	重量 WeightKg
					功率 Power kW	级数 No. of stage			
3D7P-211-100N160	44.6	8 ~ 10	100	246	160	8	219 × 8	140 × 15	≈ 7500
3D7P-246-100N220	52	10 ~ 12			220	6			
3D7P-246-100N200		8 ~ 10			200	6			
3D7P-281-100N250	59.5	10 ~ 12			250	6			
3D7P-281-100N220		8 ~ 10			220	6			
3D7P-328-100N315	69.5	11 ~ 12.5			328	315			
3D7P-328-100N250		8 ~ 10	250	6					
3D7P-185-110N160	48.2	7.5 ~ 9	110	185	160	8			
3D7P-185-110N132		6.3 ~ 7.5			132	8			
3D7P-211-110N200	54.9	9 ~ 10		211	200	8			
3D7P-211-110N160		6.3 ~ 8			160	8			
3D7P-246-110N220	63.9	8.7 ~ 10		246	220	6			
3D7P-246-110N180		6.3 ~ 7.8			180	6			
3D7P-281-110N250	73.2	9 ~ 10		281	250	6			
3D7P-281-110N200		6.3 ~ 8			200	6			

注: 表中为标准系列参数, 应优先选取。其它可选柱塞(活塞)直径为: 45、56、70、90、125、140、160、180。

行程: 160mm, 柱塞推力: 10000Kg

Notes: Plunger diameters shown in the table are of standard series specifications that have the precedence over all others, secondly the 45, 56, 70, 90, 110, 125, 140, 160, and 180.

Stroke: 160 mm plunger thrust: 10000 kg

3D8 型油田往复泵性能参数表
 Performance Parameter of 3D8 Series Reciprocating Pumps for Oilfield

基本型号 Basic model	额定流量 Rated capacity m ³ /h	排出压力 Discharge pressure MPa	柱塞直径 Plunger dia. mm	泵速 Pump speed min-1	电机 Motor		进口外径 × 壁厚 Inlet dia. × wall thickness mm	出口外径 × 壁厚 Outlet dia. × wall thickness mm	重量 WeightKg
					功率 Power kW	级数 No. of stage			
3D8-177-50N315	11.2	68 ~ 75	50	177	315	6	114 × 6	114 × 25	≈ 9000
3D8-177-50N250		50 ~ 60			250	6			
3D8-198-50N355	12.5	68 ~ 78		198	355	6			
3D8-198-50N280		50 ~ 60			280	6			
3D8-220-50N400	13.9	70 ~ 80		220	400	6			
3D8-220-50N315		55 ~ 63			315	6			
3D8-248-50N450	15.6	70 ~ 80	248	450	6				
3D8-248-50N355		50 ~ 63		355	6				
3D8-177-65N355	18.8	45 ~ 50	65	177	355	6			
3D8-177-65N280		35 ~ 40			280	6			

基本型号 Basic model	额定流量 Rated capacity m ³ /h	排出压力 Discharge pressure MPa	柱塞直径 Plunger dia. mm	泵速 Pump speed min-1	电机 Motor		进口外径 × 壁厚 Inlet dia. × wall thickness mm	出口外径 × 壁厚 Outlet dia. × wall thickness mm	重量 WeightKg				
					功率 Power kW	级数 No. of stage							
3D8-198-65N400	21.2	45 ~ 50	65	198	400	6	114 × 6	114 × 25	≈ 9000				
3D8-198-65N315		35 ~ 40			315	6							
3D8-220-65N450	23.9	45 ~ 50		220	450	6							
3D8-220-65N355		35 ~ 40			355	6							
3D8-248-65N500	26.9	45 ~ 50		248	500	6							
3D8-248-65N400		35 ~ 40			400	6							
3D8-157-80N315	26.2	28 ~ 32	80	157	315	6	168 × 7	140 × 25	≈ 10000				
3D8-157-80N250	29.5	20 ~ 25			177	250				6			
3D8-177-80N315		27 ~ 30		315		6							
3D8-177-80N250		20 ~ 24		250	6								
3D8-198-80N355		32.9		27 ~ 30	198	355				6			
3D8-198-80N280	20 ~ 24			280		6							
3D8-220-80N400	36.6	27 ~ 31		220	400	6							
3D8-220-80N315		21 ~ 24			315	6							
3D8-157-100N280	41.5	17 ~ 19		100	157	280				6	219 × 8	140 × 15	≈ 11000
3D8-157-100N250		13 ~ 17				250				6			
3D8-177-100N315	46.8	17 ~ 19			177	315				6			
3D8-177-100N280		13 ~ 17				280				6			
3D8-198-100N355	52.5	17 ~ 19.5			198	355				6			
3D8-198-100N315		13 ~ 17				315				6			
3D8-220-100N400	58.2	17.5 ~ 20	220		400	6							
3D8-220-100N355		13 ~ 17.5			355	6							
3D8-139-125N250	57.5	11 ~ 12.5	125		139	250	6	219 × 8	140 × 15	≈ 11000			
3D8-139-125N200		9 ~ 10				200	6						
3D8-157-125N280	65	11 ~ 12.5			157	280	6						
3D8-157-125N250		9 ~ 11				250	6						
3D8-177-125N315	73.2	11 ~ 12.5			177	315	6						
3D8-177-125N280		9 ~ 11				280	6						
3D8-198-125N355	81.8	11 ~ 12.5		198	355	6							
3D8-198-125N315		9 ~ 11			315	6							
3D8-124-140N220	65.5	9 ~ 10		140	124	220	6				219 × 8	140 × 15	≈ 11000
3D8-124-140N180		7 ~ 8				180	6						
3D8-139-140N250	73.2	9 ~ 10			139	250	6						
3D8-139-140N200		7 ~ 8				200	6						
3D8-157-140N280	82.8	9 ~ 10			157	280	6						
3D8-157-140N220		8 ~ 8				220	6						
3D8-177-140N315	93.2	9 ~ 10	177		315	6							
3D8-177-140N250		7 ~ 8			250	6							

注：表中为标准系列参数，应优先选取。其它可选柱塞直径为：56、70、90、110、125、140、160、180、200
行程：200mm， 柱塞推力：16000Kg

Notes: Plunger diameters shown in the table are of standard series specifications that have the precedence over all others,
 secondly the 56, 70, 90, 110, 125, 140, 160, 180 and 200.

Stroke: 200 mm plunger thrust:16000 kg

3D9 型油田往复泵性能参数表
Performance Parameter of 3D9 Series Reciprocating Pumps for Oilfield

基本型号 Basic model	额定流量 Rated capacity m ³ /h	排出压力 Discharge pressure MPa	柱塞直径 Plunger dia. mm	泵速 Pump speed min-1	电机 Motor		进口外径 × 壁厚 Inlet dia. × wall thickness mm	出口外径 × 壁厚 Outlet dia. × wall thickness mm	重量 WeightKg
					功率 Power kW	级数 No. of stage			
3D9-157-70N500	22.3	54 ~ 60	70	157	500	6	114 × 6	114 × 25	≈ 20000
3D9-157-70N400		43 ~ 48			400	6			
3D9-177-70N560	25.5	54 ~ 60		177	560	6			
3D9-177-70N450		43 ~ 48			450	6			
3D9-198-70N630	28.7	54 ~ 60		198	630	6			
3D9-198-70N500		43 ~ 48			500	6			
3D9-157-80N500	30	41 ~ 46	* 80	157	500	6	168 × 7	140 × 25	≈ 21000
3D9-157-80N400		32 ~ 37			400	6			
3D9-177-80N560	34	41 ~ 46		177	560	6			
3D9-177-80N450		32 ~ 37			450	6			
3D9-198-80N630	38	41 ~ 46		198	630	6			
3D9-198-80N500		32 ~ 37			500	6			
3D9-220-80N710	42	41 ~ 46	220	710	6				
3D9-220-80N560		32 ~ 37		560	6				
3D9-157-90N500	38.2	32 ~ 36	90	157	500	6	168 × 7	140 × 25	≈ 21000
3D9-157-90N400		26 ~ 30			400	6			
3D9-177-90N560	43	32 ~ 36		177	560	6			
3D9-177-90N450		26 ~ 30			450	6			
3D9-198-90N630	48	32 ~ 36		198	630	6			
3D9-198-90N500		26 ~ 30			500	6			
3D9-220-90N710	54	32 ~ 36	220	710	6				
3D9-220-90N560		26 ~ 30		560	6				
3D9-157-100N500	47	26 ~ 30	* 100	157	500	6	219 × 8	168 × 18	≈ 22000
3D9-157-100N400		21 ~ 24			400	6			
3D9-177-100N560	53	26 ~ 30		177	560	6			
3D9-177-100N450		21 ~ 24			450	6			
3D9-198-100N630	60	26 ~ 30		198	630	6			
3D9-198-100N500		21 ~ 24			500	6			
3D9-220-100N710	67	26 ~ 30	220	710	6				
3D9-220-100N560		21 ~ 24		560	6				
3D9-157-110N500	57.5	22 ~ 24	110	157	500	6	219 × 8	168 × 18	≈ 22000
3D9-157-110N400		17 ~ 20			400	6			
3D9-177-110N560	65	22 ~ 24		177	560	6			
3D9-177-110N450		17 ~ 20			450	6			

基本型号 Basic model	额定流量 Rated capacity m ³ /h	排出压力 Discharge pressure MPa	柱塞直径 Plunger dia. mm	泵速 Pump speed min-1	电机 Motor		进口外径 × 壁厚 Inlet dia. × wall thickness mm	出口外径 × 壁厚 Outlet dia. × wall thickness mm	重量 WeightKg				
					功率 Power kW	级数 No. of stage							
3D9-198-110N630	73	22 ~ 24	110	198	630	6	219 × 8	168 × 18	≈ 22000				
3D9-198-110N500		17 ~ 20			500	6							
3D9-220-110N710	81	22 ~ 24		220	710	6							
3D9-220-110N560		17 ~ 20			560	6							
3D9-139-125N450	66	17 ~ 19	* 125	139	450	6	219 × 8	168 × 18	≈ 22000				
3D9-139-125N355		13 ~ 15			355	6							
3D9-157-125N500	75	17 ~ 19		157	500	6							
3D9-157-125N400		13 ~ 15			400	6							
3D9-177-125N560	84	17 ~ 19		177	560	6							
3D9-177-125N450		13 ~ 15			450	6							
3D9-198-125N630	95	17 ~ 19		198	630	6							
3D9-198-125N500		13 ~ 15			500	6							
3D9-124-140N400	74	13.5 ~ 15		* 140	124	400				6	219 × 8	168 × 18	≈ 22000
3D9-124-140N315		10.5 ~ 12				315				6			
3D9-139-140N450	83	13.5 ~ 15			139	450				6			
3D9-139-140N355		10.5 ~ 12				355				6			
3D9-157-140N500	94	13.5 ~ 15	157		500	6							
3D9-157-140N400		10.5 ~ 12			400	6							
3D9-177-140N560	105	13.5 ~ 15	177		560	6							
3D9-177-140N450		10.5 ~ 12			450	6							

注: 表中带*为标准系列, 应优先选取。其它可选柱塞直径为: 160、180、200、225。

行程: 230mm, 柱塞推力: 23000Kg

Notes: Plunger diameters marked with*are of standard series specifications that have the precedence over all others, secondly the160, 180, 200 and 225.

Stroke: 230 mm plunger thrust: 23000 kg

5D6P 型油田往复泵性能参数表
Performance Parameter of 5D6P Series Reciprocating Pumps for Oilfield

基本型号 Basic model	额定流量 Rated capacity m ³ /h	排出压力 Discharge pressure MPa	柱塞直径 Plunger dia. mm	泵速 Pump speed min-1	电机 Motor		进口外径 × 壁厚 Inlet dia. × wall thickness mm	出口外径 × 壁厚 Outlet dia. × wall thickness mm	重量 WeightKg
					功率 Power kW	级数 No. of stage			
5D6P-185-50N160	12.7	27 ~ 32	50	185	160	6	140 × 8	89 × 16	≈ 7500
5D6P-185-50N132		22 ~ 27			132	6			
5D6P-200-50N160	13.7	25 ~ 31		200	160	8			
5D6P-200-50N132		21 ~ 25			132	8			
5D6P-230-50N180	15.5	27 ~ 31		230	180	6			
5D6P-230-50N160		22 ~ 27			160	6			

基本型号 Basic model	额定流量 Rated capacity m ³ /h	排出压力 Discharge pressure MPa	柱塞直径 Plunger dia. mm	泵速 Pump speed min-1	电机 Motor		进口外径 × 壁厚 Inlet dia. × wall thickness mm	出口外径 × 壁厚 Outlet dia. × wall thickness mm	重量 WeightKg	
					功率 Power kW	级数 No. of stage				
5D6P-280-50N220	19.1	28 ~ 31	50	280	220	4	140 × 8	89 × 16	≈ 7500	
5D6P-280-50N180		22 ~ 25			180	4				
5D6P-344-50N280	23.5	29 ~ 32		344	280	4				
5D6P-344-50N220		23 ~ 25			220	4				
5D6P-185-65N160	21.3	17 ~ 20	65	185	160	6				
5D6P-185-65N132		14 ~ 17			132	6				
5D6P-200-65N160	23.4	15 ~ 19		200	160	8				
5D6P-200-65N132		13 ~ 15			132	8				
5D6P-230-65N180	27.1	16 ~ 18		230	180	6				
5D6P-230-65N160		13 ~ 16			160	6				
5D6P-280-65N220	32.7	17 ~ 18		280	220	4				
5D6P-280-65N180		13 ~ 15			180	4				
5D6P-344-65N280	40.2	17 ~ 19		344	280	4				
5D6P-344-65N220		14 ~ 15			220	4				
5D6P-185-80N160	32.7	11 ~ 12.5		80	185	160	6	219 × 8	140 × 15	≈ 8500
5D6P-185-80N132		9 ~ 11				132	6			
5D6P-200-80N160	35.5	10 ~ 12	200		160	8				
5D6P-200-80N132		8 ~ 10			132	8				
5D6P-230-80N180	41.1	10 ~ 12	230		180	6				
5D6P-230-80N160		9 ~ 10			160	6				
5D6P-280-80N220	49.6	11 ~ 12	280		220	4				
5D6P-280-80N180		9 ~ 10			180	4				
5D6P-344-80N280	60.8	11 ~ 12.5	344		280	4				
5D6P-344-80N220		9 ~ 10			220	4				
5D6P-185-100N160	52.3	7 ~ 8	100		185	160	6			
5D6P-185-100N132		6 ~ 7				132	6			
5D6P-200-100N160	56.1	6.3 ~ 8		200	160	8				
5D6P-200-100N132		5 ~ 6.3			132	8				
5D6P-230-100N180	64.6	7 ~ 8		230	180	6				
5D6P-230-100N160		5.6 ~ 7			160	6				
5D6P-280-100N220	78.9	7 ~ 8		280	220	4				
5D6P-280-100N180		5.6 ~ 6.3			180	4				
5D6P-344-100N280	96.9	7 ~ 8		344	280	4				
5D6P-344-100N220		5.7 ~ 6.3			220	4				

注: 表中为标准系列参数, 应优先选取。其它可选柱塞(活塞)直径为: 36、45、56、70、90、110、125、140。

行程: 160mm, 柱塞推力: 6300Kg

Notes: Plunger diameters shown in the table are of standard series specifications that have the precedence over all others, secondly the 36, 45, 56, 70, 90, 110, 125 and 140.

Stroke: 160 mm plunger thrust:6300 kg

5D7P 型往复泵性能参数表
Performance Parameter of 5D7P Series Reciprocating Pumps for Oilfield

基本型号 Basic model	额定流量 Rated capacity m ³ /h	排出压力 Discharge pressure MPa	柱塞直径 Plunger dia. mm	泵速 Pump speed min-1	电机 Motor		进口外径 × 壁厚 Inlet dia. × wall thickness mm	出口外径 × 壁厚 Outlet dia. × wall thickness mm	重量 WeightKg
					功率 Power kW	级数 No. of stage			
5D7P-185-50N280	15.6	42 ~ 47	50	185	280	8	114 × 6	114 × 25	≈ 6500
5D7P-185-50N220		33 ~ 37			220				
5D7P-211-50N355	17.8	46 ~ 50		211	355	8			
5D7P-211-50N280		37 ~ 41			280				
5D7P-246-50N400	20.5	45 ~ 50		246	400	6			
5D7P-246-50N315		36 ~ 40			315				
5D7P-281-50N450	24.1	45 ~ 50		281	450	6			
5D7P-281-50N355		35 ~ 40			355				
5D7P-185-65N315	27.1	28 ~ 32	65	185	315	8	168 × 7	140 × 25	≈ 7200
5D7P-185-65N250		22 ~ 25			250				
5D7P-211-65N355	30.8	28 ~ 31		211	355	8			
5D7P-211-65N280		22 ~ 25			280				
5D7P-246-65N400	35.9	27 ~ 30		246	400	6			
5D7P-246-65N315		21 ~ 24			315				
5D7P-281-65N450	41.4	26 ~ 30		281	450	6			
5D7P-281-65N355		21 ~ 23			355				
5D7P-328-65N500	47.8	26 ~ 29	328	500	6				
5D7P-328-65N400		20 ~ 23		400					
5D7P-185-80N315	41.6	18 ~ 20	80	185	315	8	168 × 7	140 × 25	≈ 7200
5D7P-185-80N250		14 ~ 16			250				
5D7P-211-80N355	47.7	18 ~ 20		211	355	8			
5D7P-211-80N280		14 ~ 16			280				
5D7P-246-80N400	55.6	18 ~ 20		246	400	6			
5D7P-246-80N315		14 ~ 16			315				
5D7P-281-80N450	63.6	17 ~ 20		281	450	6			
5D7P-281-80N355		13 ~ 15			355				
5D7P-328-80N500	74	17 ~ 19	328	500	6				
5D7P-328-80N400		13 ~ 15		400					
5D7P-185-100N315	65.5	11 ~ 12.5	100	185	315	8	219 × 8	168 × 17.5	≈ 7500
5D7P-185-100N250		9 ~ 10			250				
5D7P-211-100N355	74.3	11 ~ 12.5		211	355	8			
5D7P-211-100N280		9 ~ 10			280				
5D7P-246-100N400	86.5	11 ~ 12.5		246	400	6			
5D7P-246-100N315		9 ~ 10			315				
5D7P-281-100N450	99	11 ~ 12.5		281	450	6			
5D7P-281-100N355		9 ~ 10			355				
5D7P-328-100N500	116	11 ~ 12	328	500	6				
5D7P-328-100N400		8.5 ~ 9.5		400					

基本型号 Basic model	额定流量 Rated capacity m ³ /h	排出压力 Discharge pressure MPa	柱塞直径 Plunger dia. mm	泵速 Pump speed min-1	电机 Motor		进口外径 × 壁厚 Inlet dia. × wall thickness mm	出口外径 × 壁厚 Outlet dia. × wall thickness mm	重量 WeightKg
					功率 Power kW	级数 No. of stage			
5D7P-185-110N315	80	9 ~ 10	110	185	315	8	219 × 8	168 × 17.5	≈ 7500
5D7P-185-110N250		7 ~ 8			250	8			
5D7P-211-110N355	91	9 ~ 10		211	355	8			
5D7P-211-110N280		7 ~ 8			280	8			
5D7P-246-110N400	106.5	9 ~ 10		246	400	6			
5D7P-246-110N315		7 ~ 8			315	6			
5D7P-281-110N450	122	9 ~ 10		281	450	6			
5D7P-281-110N355		7 ~ 8			355	6			
5D7P-328-110N500	143	9 ~ 10		328	500	6			
5D7P-328-110N400		7 ~ 8			400	6			

注: 表中为标准系列参数, 应优先选取。其它可选柱塞(活塞)直径为: 56、70、90、125、140、160、180。

行程: 160mm, 柱塞推力: 10000Kg

Notes: Plunger diameters shown in the table are of standard series specifications that have the precedence over all others, secondly the 56, 70, 90, 110, 125, 140, 160 and 180.

Stroke: 160 mm plunger thrust: 10000 kg

七、3DP 型油田往复泵外形尺寸图

Outline Dimension Drawing of 3DP Series Reciprocating Pumps for Oilfield

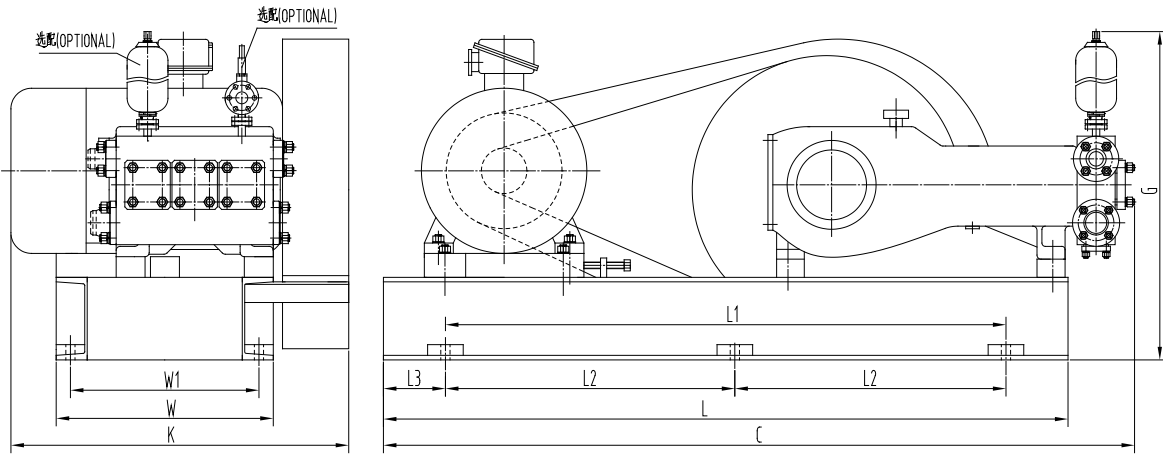

地脚螺栓孔尺寸示意图
CENTER DISTANCE OF ANCHOR BOLT HOLES

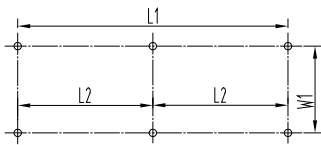

泵型号 MODEL	L	L1	L2	L3	W	W1	泵组外形尺寸 OUTLINE DIMENSION OF PUMP UNIT CxKxG(LxWxH) CxKxG(LxWxH)	地脚螺栓 ANCHOR BOLT 数量-规格x长度 QTY-SPECxLENGTH
3D2P	1360	1300	30	500	440		~1700x680x770	4-M20x4.00
3D3P	1550	1000	275	520	550		~2100x980x950	4-M20x4.00
3D4P	1980	1000	530	600	540		~2350x1100x1100	4-M20x4.00
3D6P	2350	1050	125	730	660		~2800x1250x1200	6-M24x500
3D7P	2800	1325	700	820	750		~3150x1350x1300	6-M24x500

八、5DP 型油田往复泵外形尺寸图

Outline Dimension Drawing of 5DP Series Reciprocating Pumps for Oilfield

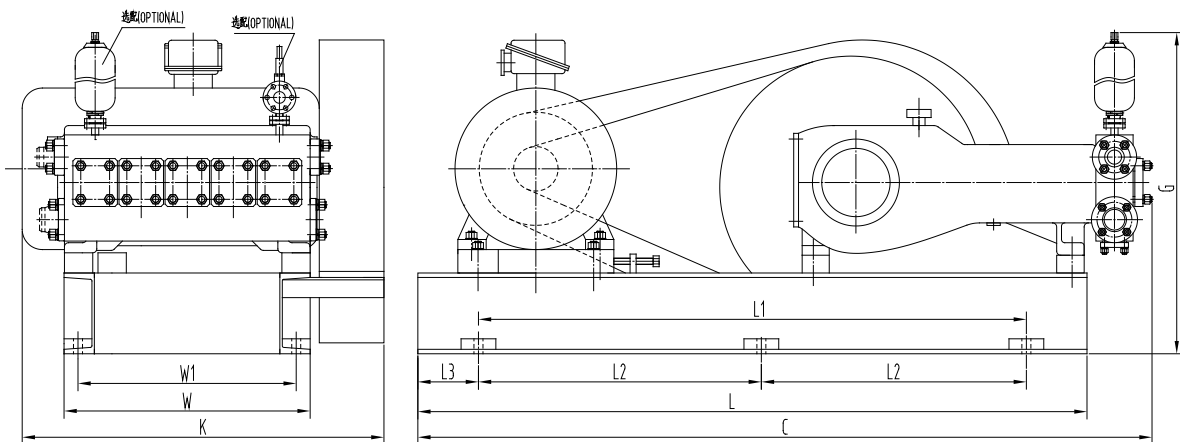

地脚螺栓孔尺寸示意图
CENTER DISTANCE OF ANCHOR BOLT HOLES

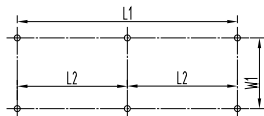

泵型号 MODEL	L	L1	L2	L3	W	W1	泵组外形尺寸 OUTLINE DIMENSION OF PUMP UNIT CxKxG(LxWxH) CxKxG(LxWxH)	地脚螺栓 ANCHOR BOLT 数量-规格x长度 QTY-SPECxLENGTH
5D6P	2350	2100	1050	125	730	660	~2800x1250x1200	6-M24x500
5D7P	2800	2650	1325	700	820	750	~3150x1350x1300	6-M24x500